



BATHROOM FURNITURE · MOBILIER DE SALLE DE BAIN

Vanity top · Dessus de meuble-lavabo

# VT-SQ19-096122S

## FOR SINGLE-HOLE FAUCET INSTALLATION \*POUR INSTALLATION MONOTROU

Pre-drilled for single-hole faucet  
\*Pré-percé pour robinet monotrou

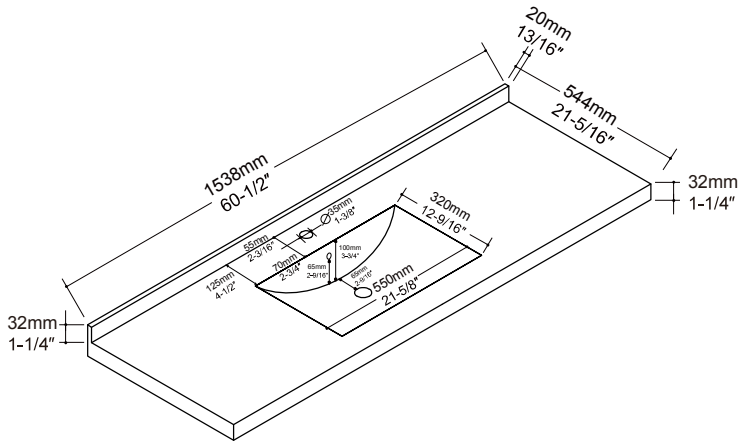

## FOR 4" FAUCET INSTALLATION \*POUR INSTALLATION ROBINET 4"

3 holes - 4" spread - needs to be drilled  
\*3 trous - 4" centre - doit être percé

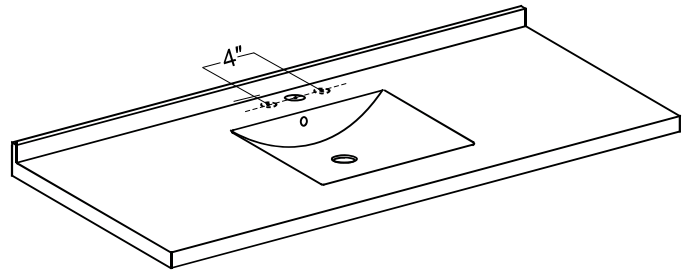

## FOR 8" FAUCET INSTALLATION \*POUR INSTALLATION ROBINET 8"

3 holes - 8" spread - needs to be drilled  
\*3 trous - 8" centre - doit être percé

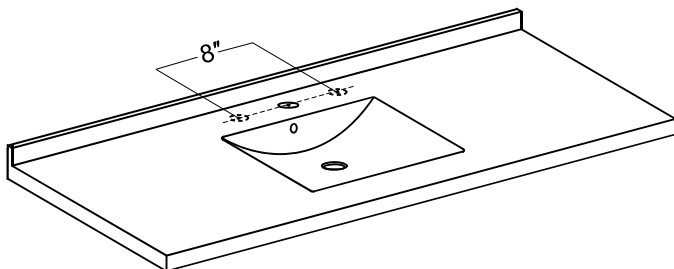

### Tools You Will Need - Outils Requis



Power drill  
Perceuse électrique



Drill bit 1/4"  
Mèche de perceuse électrique 1/4"



Hole saw drill bit 1  
Scie trépan  
Ø30mm for 4" faucet installation  
\*Ø30mm pour installation de robinet 4"  
Ø35mm for 8" faucet installation  
\*Ø35mm pour installation de robinet 8"



Hole saw drill bit 2  
Scie trépan  
Ø30mm for 4" faucet installation  
\*Ø30mm pour installation de robinet 4"  
Ø35mm for 8" faucet installation  
\*Ø35mm pour installation de robinet 8"

**Step 1 / Étape 1**

Reverse the top  
\*Retourner le dessus

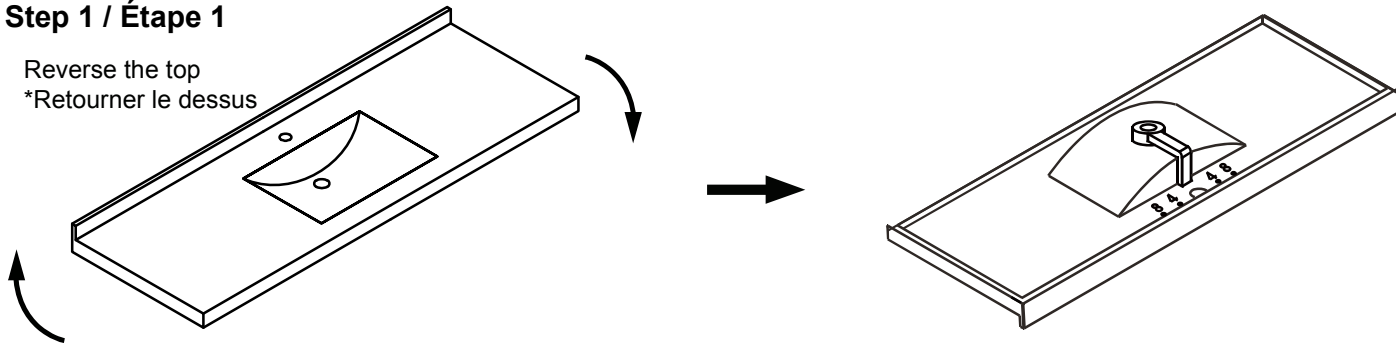

**3 holes - 4" spread / 3 trous - 4" centre**

**Step 2 / Étape 2**

Drill 4 small holes next to the "4" letter marks from the underside  
\*Percer 4 petits trous à côté des "4" marqués sur le dessous

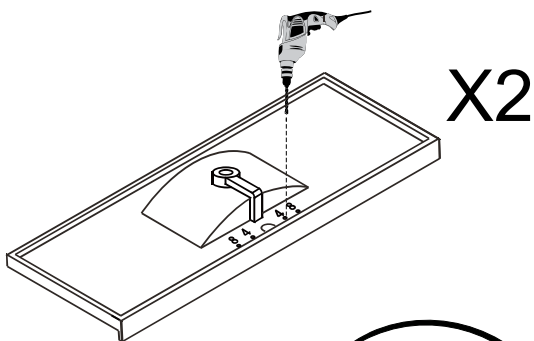

**Step 3 / Étape 3**

Drill through the 4 faucet holes from top side with the hole saw  
\*Percer les 4 trous de robinet sur le dessus avec la scie trépan

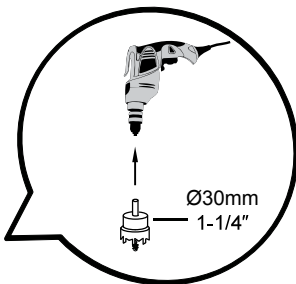
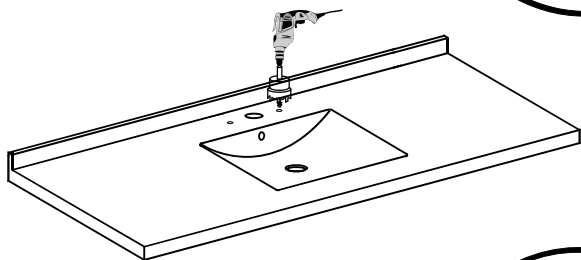

**Step 4 / Étape 4**

Smooth out the drilled faucet holes surface  
\*Lisser les trous de robinet sur la surface

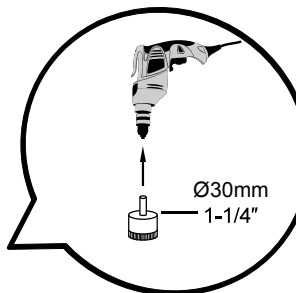
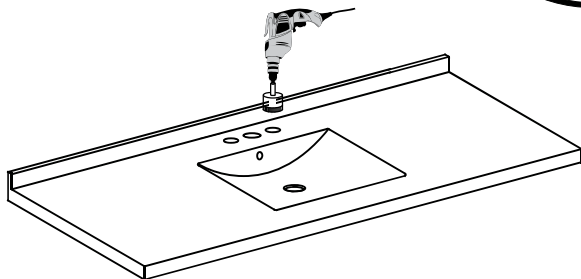

**3 holes-8"spread / 3 trous-8"centre**

**Step 2 / Étape 2**

Drill 4 small holes next to the "8" letter marks from the underside  
\*Percer 4 petits trous à côté des "8" marqués sur le dessous

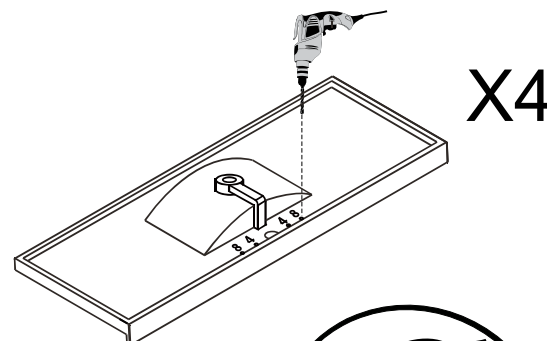

**Step 3 / Étape 3**

Drill through the 4 faucet holes from top side with the hole saw  
\*Percer les 4 trous de robinet sur le dessus avec la scie trépan

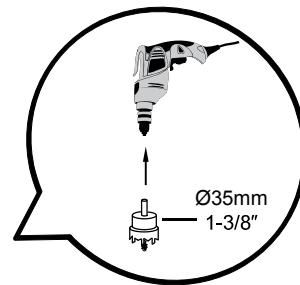
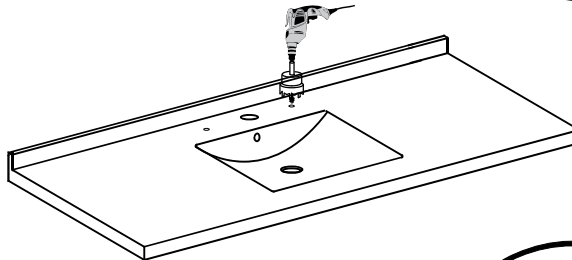

**Step 4 / Étape 4**

Smooth out the drilled faucet holes surface  
\*Lisser les trous de robinet sur la surface

